

MODEL # FWP-PC-1590-1

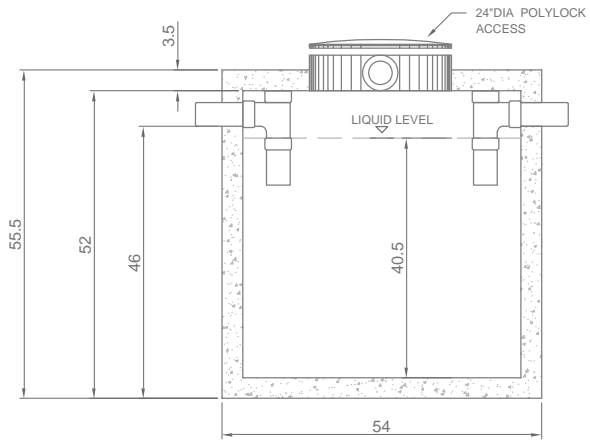

SECTION

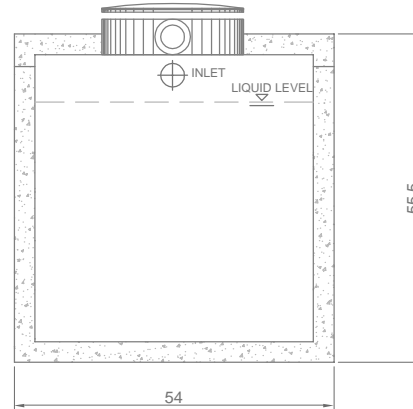

SIDE

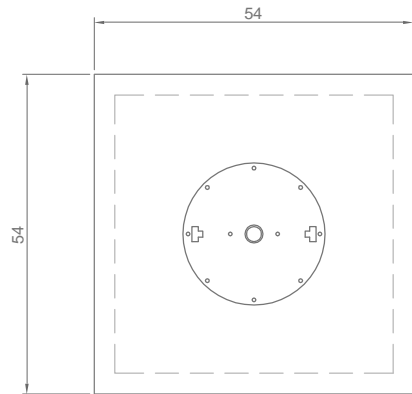

PLAN

DESIGN DATA

FRASER WAY PRECAST MODEL # FWP-PC-1590-1
WEIGHT: 4550 LBS

WORKING VOLUMES:
1ST CHAMBER= 1590 L 350 I.G.

CONCRETE TANK STRUCTURAL REINFORCING
(STRUCTURAL REINFORCING DESIGN BY OTHERS)

BASE REBAR
10M @ 12" (305mm) O.C. ON BOTTOM w/12" (305mm) BENT OVERLAP SIDES,
2PCS 10M UNDER DIVIDE
4x4 / 10 GA. WWM REINFORCING w/12" (305mm)
WRAP EACH END

SIDEWALL REBAR
2-10M (TOTAL 2) REBAR BENT COLD AT CORNERS
WELDED IN LOOP
4x4 / 10 GA. WWM REINFORCING w/12" (305mm)
WRAP EACH END

GASKET: CONCEAL CS-120

CONCRETE STRENGTH: 25 MPa MINIMUM
(USE IN NON-SULPHATE SOILS ONLY)

ALL DIMENSIONS SHOWN IN INCHES

FRASERWAY PRECAST LTD

22765 FRASER HIGHWAY
LANGLEY, BC V3A 4R6
TEL: 604-534-2911 FAX: 604-533-3238
EMAIL: INFO@FRASERWAYPRECAST.COM
WWW.FRASERWAYPRECAST.COM

**350 gal - 1590 L - 1 COMPARTMENT, 1 PIECE
PUMP CHAMBER
PLAN, SIDE AND SECTION**

DRAWN: EJP	SHEET: 1 / 1	FILE NO. 350	REV:
DATE: JUNE 26, 2010	REV DATE: REV TYPE:		